

BILL OF MATERIALS

ITEM	QTY.	DESCRIPTION	PART No.	SUFFIX
1	1	WHEEL BLOCK WELDMNT (LEFT HAND)	1068	
2	1	SAFETY CAM	1014	
3	1	5 1/4" PHENOLIC WHEEL	1036	
4	1	CAM PIN	1028	
5	1	GUIDE SHOE	1022	
6	1	CAM SPRING	1029	
7	2	ROLLER GUIDE	1017	
8	1	WHEEL RETAINER	1030	
9	1	CAM WASHER	1031	
10	1	BUTTON HEAD SOCKET CAP SCR 1/4-20 x 1/2"	2583	
11	2	LINKAGE PLATE	1032	
12	2	LINK PINS	1033	
13	2	SHOULDER BOLT - SOCKET HEAD 5/8"Ø x 1 1/4"	2340	
14	2	HHCS 5/8-11 x 2 1/4", GRADE 8		
15	6	LOCKWASHER, 5/8"		
16	2	COTTER PIN - 5/32" x 1 1/4"		
17	1	WIRE ROPE THIMBLE 3/8"Ø ROPE - GALV.	1034	
18	4	HHCS, 5/8-11 x 1 1/4"		
19	1	PHENOLIC WHEEL PIN	1058	

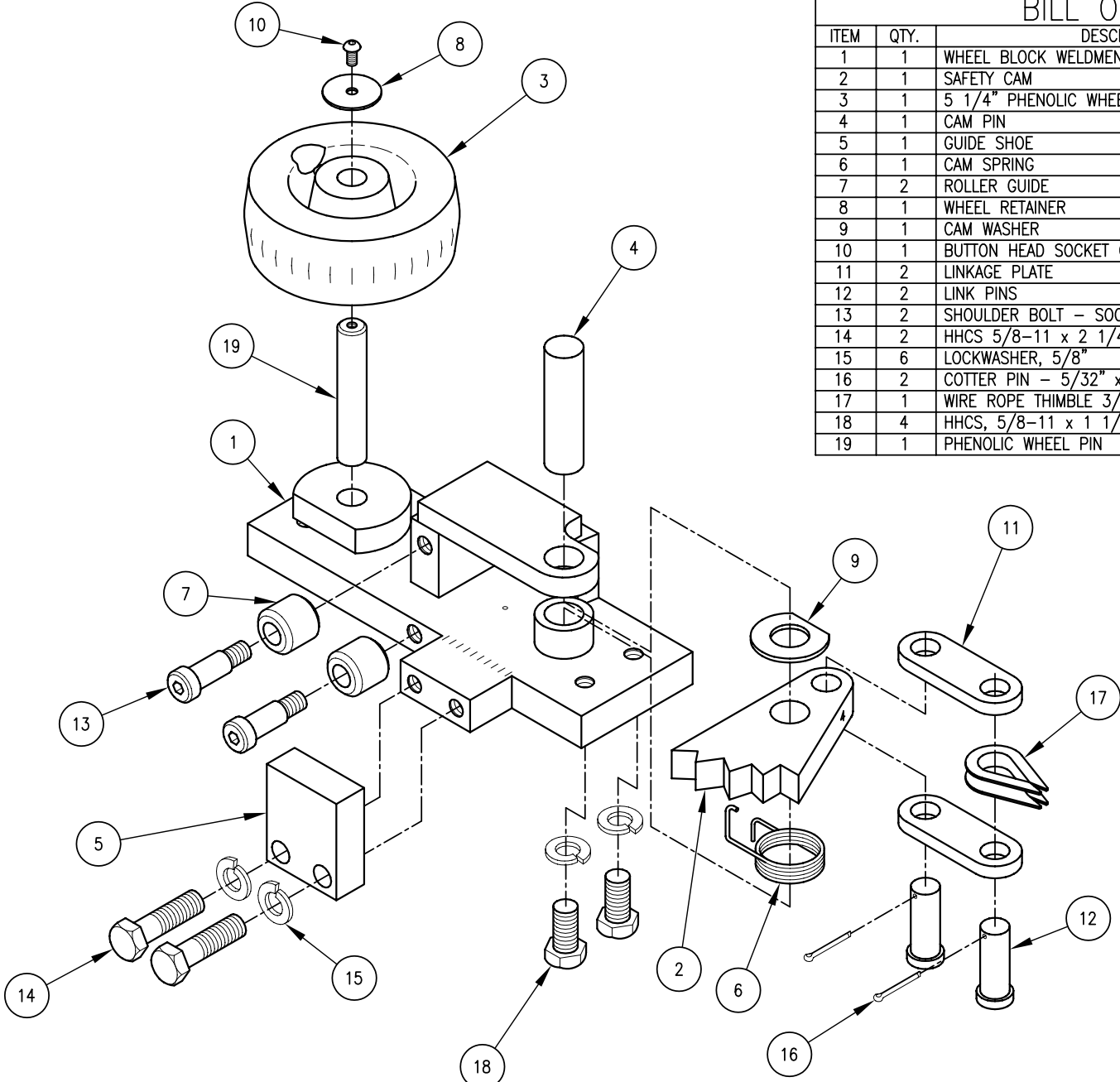

UPPER WHEEL BLOCK/SAFETY ASSEMBLY
PHENOLIC WHEEL

DATE: 8-13-91
DRN BY DFK

1069-LH 1

REV