

**PRESSURE SWITCH
RELIEF VALVE ADJUSTMENT**

1. REMOVE TERMINAL BLOCK.
2. SELECT CORRECT SIZE OF ALLEN WRENCH.
3. TURN VALVE CLOCKWISE TO INCREASE PRESSURE, TURN COUNTER CLOCKWISE TO DECREASE PRESSURE.
4. REPLACE TERMINAL BLOCK.

HEX COVER
LL2355

RELEASE KNOB

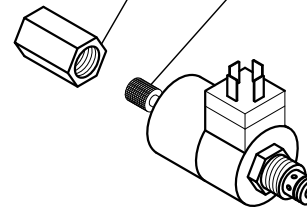

DOWN SOLENOID

- * TURN COUNTER CLOCKWISE FOR MANUAL LOWERING (KNOB WILL POP OUT)
- * PUSH IN AND TURN CLOCKWISE TO RESUME ELECTRICAL OPERATION

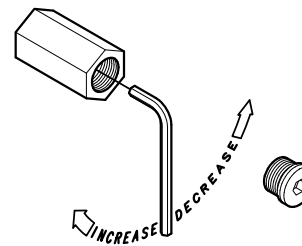

PRESSURE RELIEF VALVE DETAIL

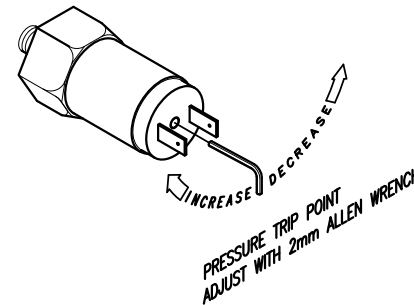

PRESSURE SWITCH DETAIL



HYDRAULIC POWER UNIT
5 HP

DATE: 8-30-91

DRN BY DFK

1353

REV
7